

# **PS-3415/3415E**

## **Fanless LCD Touch Terminal**

### **User Manual**



## **Package Contents**

- ✓ Fanless LCD touch terminal.....(x 1)
- ✓ Power adaptor.....(x 1)
- ✓ Power cord.....(x 1)
- ✓ User Manual.....(x 1)
- ✓ Recovery DVD.....(x 1)  
(for pre-loaded OS model only)

## **FCC NOTES**

This equipment has been tested and found to comply with the limits for a Class A digital device, pursuant to part 15 of the FCC Rules. These limits are designed to provide reasonable protection against harmful interference when the equipment is operated in a commercial environment. This equipment generates, uses, and can radiate radio frequency energy and, if not installed and used in accordance with the instruction manual, may cause harmful interference to radio communications. Operation of this equipment in a residential area is likely to cause harmful interference in which case the user will be required to correct the interference at his own expense.

This device complies with part 15 of the FCC Rules. Operation is subject to the following two conditions: (1) This device may not cause harmful interference, and (2) this device must accept any interference received, including interference that may cause undesired operation.

## **CE CLASS A WARNING**

This equipment is compliant with Class A of CISPR 32. In a residential environment this equipment may cause radio interference.

## **WARRANTY LIMITS**

Warranty will terminate automatically when the machine is opened by any person other than the authorized technicians. The user should consult his/her dealer for the problem happening. Warranty voids if the user does not follow the instructions in application of this merchandise. The manufacturer is by no means responsible for any damage or hazard caused by improper application.

## **警告使用者**

此為甲類資訊技術設備，於居住環境中使用時，可能會造成射頻擾動，在此種情況下，使用者會被要求採取某些適當的對策。

## **SAFETY INSTRUCTIONS**

This equipment is not suitable for use in locations where children are likely to be present.

**13110902040 Ver. C0**

## CONSIGNES DE SÉ CURITÉ

Cet équipement ne convient pas à une utilisation dans des lieux pouvant accueillir des enfants.

### BATTERY CAUTION NOTES

- Dispose of used batteries according to the instructions.
- Replacement of a battery with an incorrect type that can defeat a safeguard (for example, in the case of some lithium battery types)
- Disposal of a battery into fire or a hot oven, or mechanically crushing or cutting of a battery that can result in an explosion.
- Leaving a battery in an extremely high temperature surrounding environment that can result in an explosion or the leakage of flammable liquid or gas.
- A battery subjected to extremely low air pressure that may result in an explosion or the leakage of flammable liquid or gas.

### BATTERIE ATTENTION NOTES

- Jetez les piles usagées conformément aux instructions.
- Remplacement d'une batterie avec un type incorrect qui peut annuler une sauvegarde (par exemple, dans le cas de certains types de batterie au lithium)
- Mise au rebut d'une batterie dans le feu ou dans un four chaud, ou écrasement ou coupure mécanique d'une batterie pouvant entraîner une explosion.
- Laisser une batterie dans un environnement environnant à des températures extrêmement élevées pouvant entraîner une explosion ou la fuite de liquide ou de gaz inflammable.
- Une batterie soumise à une pression atmosphérique extrêmement basse pouvant provoquer une explosion ou une fuite de liquide ou de gaz inflammable.

### 警告

本電池如果更換不正確會有爆炸的危險，請依製造商說明書處理用過之電池。

## Product Features

- Fanless terminal
- Intel® Celeron® Bay Trail J1800 Celeron processor, up to 2.58 GHz, Dual Core, 1MB Cache for PS-3415 / Intel® Celeron® Processor J1900 (2M Cache, up to 2.42 GHz) for PS-3415E
- Foldable base that allows PS Series to be configured into different configurations
- Projected-capacitive touch
- Integrated structure for side mount upgrade kit: SA-105/205/305/405/505; back mount display: LM-6807U / 6810U and PD-360R/360UE/2609UE/6807U; 40-key dynakey attachment with MSR or RFID option: KP-500
- Water resistant structure designed for easy cleaning

# Views of the PS-3415/3415E

## Front View

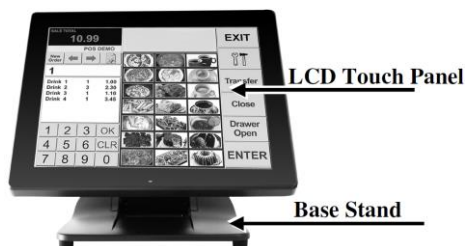

## Rear View

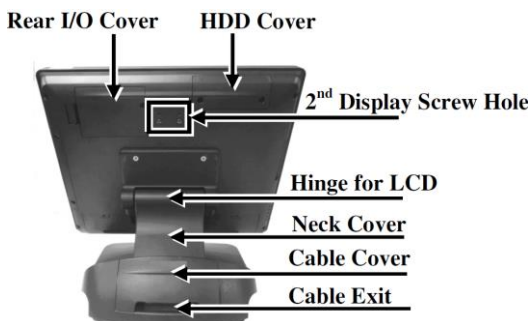

## Left Side View



## Right Side View

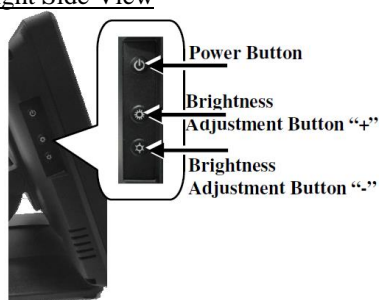

## Bottom View

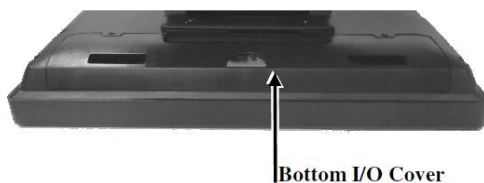

## View of I/O Interface

### Top I/O Ports



- 1 COM4 Port
- 2 USB 2.0 Port

### Rear I/O Ports

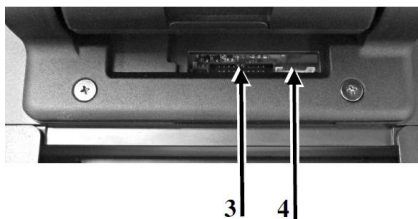

- 3 Parallel (LPT) Port Connector
- 4 PS/2\_KB Pin Header

**※ The top I/O ports are provided for COM-based and USB-based peripheral devices, for example, customer display.**

### Bottom I/O Ports

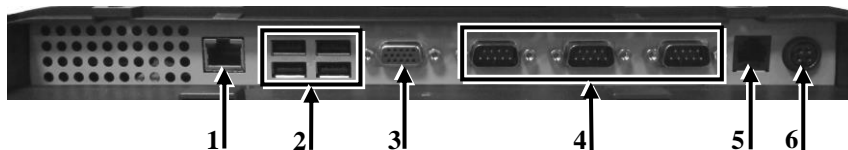

- |                         |                             |
|-------------------------|-----------------------------|
| 1 RJ45 LAN Port         | 2 USB 2.0 Port              |
| 3 VGA Port              | 4 COM Port (COM3/COM2/COM1) |
| 5 RJ11 Cash Drawer Port | 6 12VDC-IN Power Jack       |

## Positioning your POS for a Perfect Viewing Angle

The adjustable Gen7 base is designed to help you determine an ideal position for PS-3415/3415E using its unique tilt adjustment mechanism. As the below figures suggest, Gen7 base basically provides three standard positioning solutions for your terminal: **Flat Folded mode**, **Low Profile mode**, and **Full Extended mode**.

## PS-3415/3415E with Gen7 Base



**Flat Folded mode**



**Low Profile mode**



**Full Extended mode**

In general, PS-3415/3415E will be set up beforehand in **Flat Folded** mode and then packaged into the box for shipping. After it is unpacked, you may re-adjust the terminal in either **Low Profile mode** or **Full Extended mode** according to your situation. Below will provide instructions on how to adjust the specific base connected to the POS system. As a reminder, please be careful not to touch the LCD panel while setting up the tilt angle. Please refer to the following instructions on how to switch among different positioning modes to find an ideal viewing angle for PS-3415/3415E with Gen7 base.

1. Unpack XT-3415/3415E, which is supposed to be set in flat folded mode, out of the package box and then lay your POS system on a flat surface.
2. Steady the base with one hand, and then tilt the screen downwards.



3. Position your terminal in **Full Extended mode**

- 3.1 After grabbing the bottom edge of the screen with your hand, gently move the screen upward until the screen is locked into place with a click sound.



- 3.2 Support the screen with one hand holding onto its bottom edge. Then, while pulling the lever backwards, move the display upwards until the lever is snapped into the lower hook to raise the screen as shown in the below figure.

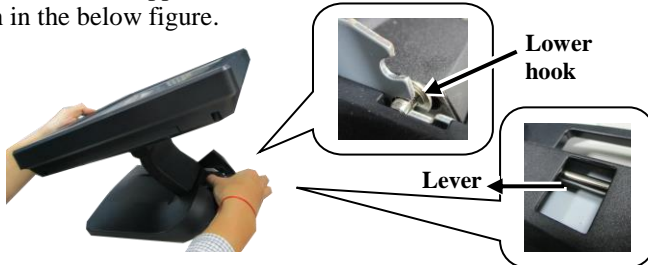

- 3.3 With the screen facing toward you, tilt the screen up or down to your desired angle. Please do not press on the LCD panel while setting up the tilt angle.
- 3.4 Remove the cable cover from the base.



- 3.5 Fix the base with two #/6/32-14L screws.

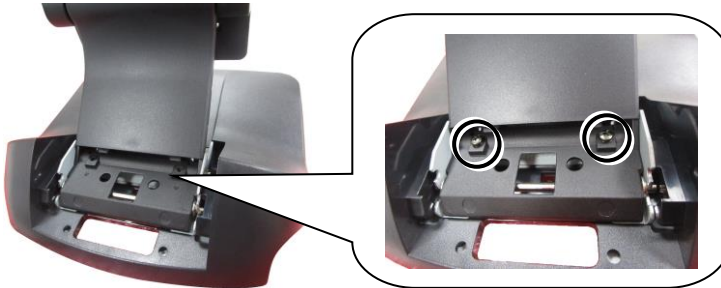

4. Return your terminal back to **Flat Folded mode** from **Full Extended mode**.

- 4.1 Remove the cable cover from the base.



- 4.2 Remove the two screws from the base.



**Remove the two screws.**



- 4.3 Tilt your screen in a horizontal position.



- 4.4 Support the screen with one hand holding onto its bottom edge. While pulling the lever backwards, move the display downwards until the lever is lifted off the hook as shown in the figure.



**Hook**



**Lever**

- 4.5 Push the cable cover back.



- 4.6 Tilt the screen again to the horizontal position.



5. Position the terminal in **Low Profile mode**.

- 5.1 Follow Step 4 to set up the terminal in Flat Folded mode.



- 5.2 Tilt the screen all the way down



- 5.3 To tilt screen up or down to your desired angle, please be advised to keep the base steady with one hand to do so. Do NOT press on the LCD panel while setting up the tilt angle.



## Installing Optional Upgrade Kits and Peripherals

PS-3415/3415E can work with multiple optional upgrade kits and peripheral devices, such as magnetic stripe reader (MSR), LCD monitor, cash drawer and the like.

Before installing an optional upgrade kit and/or peripheral device, make sure that the system is powered off and the external power source is removed from the POS box to prevent electric hazard! Failure to follow the warning description will void the product warranty!

For the detailed instruction, refer to each of the user manuals of the optional upgrade kits and peripheral devices.



## Connecting Power Adapter and I/O Cables

Before connecting power adapter and I/O cables to the I/O ports of PS series terminal, please route and arranging the cables. Refer to the following step-by-step instruction of cable routing and arrangement for the details. Here, an equivalent model with GEN 7 base is taken below for example.

1. Press the circled section of the cable cover with your thumb.



2. Pull out the cable cover.



3. Push and tilt the terminal to the end in the direction as shown by the arrow.



4. Determine that the terminal is tilted to the end, as shown in the right figure.



5. Press the circled section with two thumbs and pull by force the two sides of the locking hook with two forefingers as indicated by the arrow.



6. Remove the neck cover from the base stand.



7. Tilt the terminal slightly at a little angle in the direction as shown by the arrow, making cables easily pass through the cable passage.

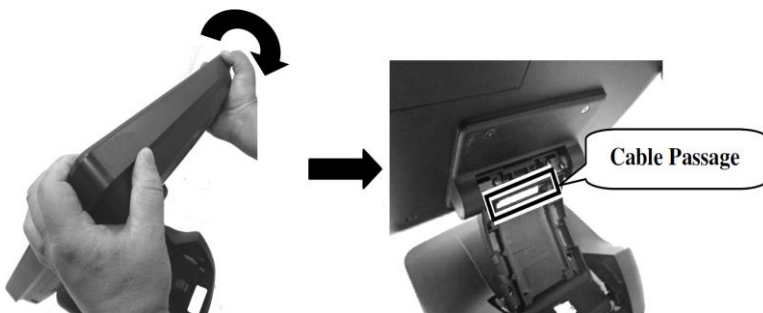

8. Make the connector, which will be connected to the I/O port of the terminal, pass through the cable passage of base stand.

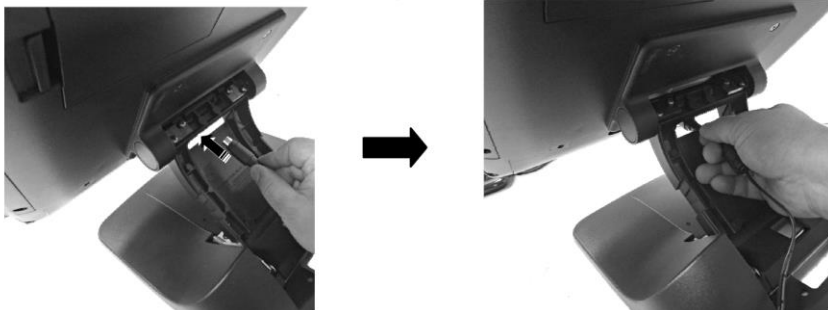

9. Push and tilt the terminal to the end in the direction as shown by the arrow.



10. Remove the bottom I/O cover with your forefinger inserting the middle hole of the cover.

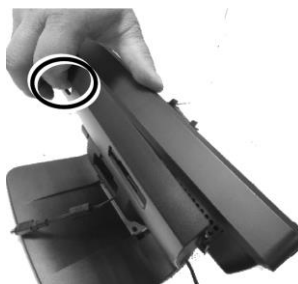

11. Connect the connector of the power adapter to the 12VDC-IN power jack.



12. Cover the bottom I/O interface and gather the I/O cables to the circled cable arrangement area, as shown below.

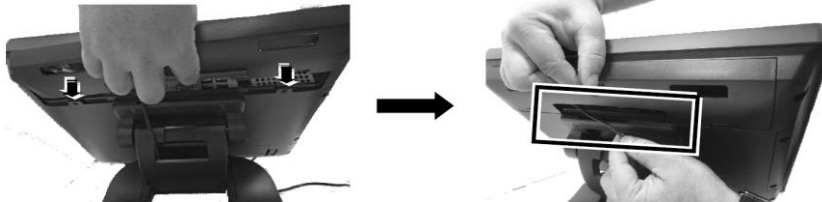

13. Push and tilt the terminal to the end in the direction as shown by the arrow.



14. Arrange well the I/O cable located at the area of neck cover.



15. Shield the I/O cable arrangement area on the neck of the base stand with the neck cover.

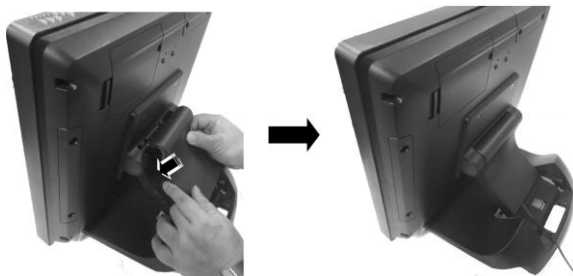

16. Shield the I/O cable exposure area with the cable cover.

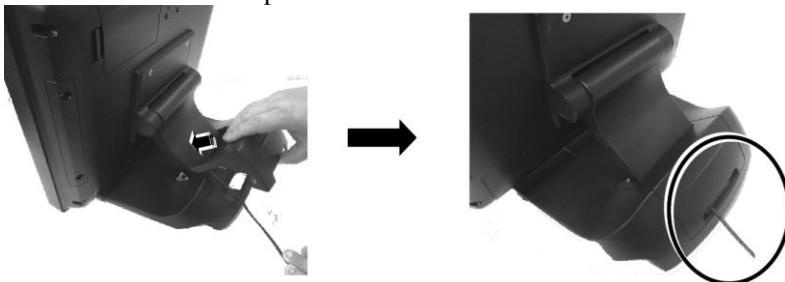

**CAUTION:** On doing insertion or extraction of a cable connector, please always hold the connector head itself instead of pulling the cable wire. Doing this could damage the cables and ports, which is considered as an artificial damage and is not covered by the warranty. The means of power cord should be connected to a socket-outlet with earthing connection.

**ATTENTION:** Lors de l'insertion ou de l'extraction d'un connecteur de câble, veuillez toujours tenir la tête du connecteur elle-même au lieu de tirer le fil du câble. Cela pourrait endommager les câbles, ce qui est considéré comme un dommage artificiel et n'est pas couvert par la garantie. Le cordon d'alimentation doit être connecté à une prise de courant avec mise à la terre.

### Powering ON the PS-3415/3415E

After connecting the power cable to the power jack of the terminal, press the power button to power on the terminal. To power it off, press the power button again.

Once powering off the system, if you want to power it on again, please wait at least 3 seconds.



If the system hangs due to a reason, such as software resource conflict, please press and hold the power button for over 10 seconds to forcedly shut down the system.

### Power LED Indicator

There is a power LED indicator located at the center of lower rim of the front side of LCD panel. After powering ON or OFF the terminal, you can read the power status from the power LED indicator. The LED status is described below.



LED	Status	Description
POWER	Solid blue	System power ON
	Solid orange	System standby

## Installing an Operating System

This product is highly professional equipment. Therefore, we do NOT encourage you to install any operating system into this machine without professional assistance. We shall not be responsible for any technical support to questions on this aspect. We suggest that you contact your dealer for OS installation.

## Operating System Recovery

For the PS-3415/3415E main system preloaded with an operating system on HDD, We provide a recovery DVD shipped with the main system for the preloaded operating system. The system integrator shall take care of software restoration after the OS is recovered.

If you plan to recover your operating system, we do NOT encourage you to recover any operating system. Please contact your service center for operating system recovery.

## Operation Environment

This terminal must NOT be operated in an environment with restricted ventilation. There must be at least 25 mm air clearance around any top or side ventilation holes with free flow of air around the unit at all times for system operation.

## Specifications

<b>System Configuration</b>	Processor	PS-3415: Intel® Celeron J1800, 2C, 2.41GHz/2.58GHz (Burst), 1M Cache (Default)  Intel® Celeron N2807, 2C, 1.58GHz/2.16GHz (Burst), 1M Cache (Option)  PS-3415E: Intel® Celeron® Processor J1900 (2M Cache, up to 2.42 GHz)
	System Memory	2GB DDR3L 1333MHz default
	Storage Device	SATA x 1 + mSATA x 1; 320GB SATA HDD default
	Power Supply	12V/40W (upgrade to 60W or higher when required)
	OS support	Windows 7 / POSReady 7 / Windows Embedded 8.1 Industry / DOS/ Linux per request
<b>Display &amp; Touch</b>	LCD	Bezel-free TFT LCD
	Resolution	1024 x 768
	Touch	Projected-capacitive touch
<b>I/O &amp; Expansion</b>	Serial Port	4, 3 x DB9 on bottom I/O plate + 1 x RJ50 on top I/O plate, 5V/12V support on all COM ports
	Parallel Port	1, via optional conversion cable
	Standard USB Port	5, 4 on bottom I/O plate + 1 on top I/O plate
	LAN Port	10 / 100 / 1000 Mb x 1
	Display Port	VGA x 1, 12V support
	CR Port	1, control 2 CR via optional Y-cable
	PS/2 Port	Pin header inside service window
	Audio	Buzzer only
	Base Stand	7th generation foldable base stand
	Power Supply	12V/40W
<b>Environmental</b>	Operating Condition	0°C - 40°C, 20%RH - 90%RH (Equipped with HDD); 0°C - 50°C, 20%RH - 90%RH (Equipped with SSD)
	Storage Condition	-20°C - 70°C, 10%RH - 90%RH

**※ The product information and specifications are subject to change without prior notice. To get the detailed information on the XT-3415/3415E, please contact your dealer or service team.**

**<MEMO>**